

Procedural Advice

Replacement instructions for EGGER laminate flooring with glueless installation system UNIfit!

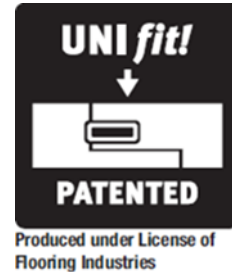

In the case of EGGER laminate flooring with glueless locking system UNIfit! is possible to replace one plank of the installed flooring area in two different ways.

1. Change a plank by removal and re-installing a partial area

If the furniture admit, start remove the laminate flooring row after row, beginning from the wall up to the damaged plank. Put up the elements row after row lifting the elements on the long side. Then you separate the short side by sliding the elements apart. Please consider that the elements lie even, when separating them on the short side.

Please put the planks by side as you took them off, row by row, to avoid any mix-up during the re-installation.

1.1.

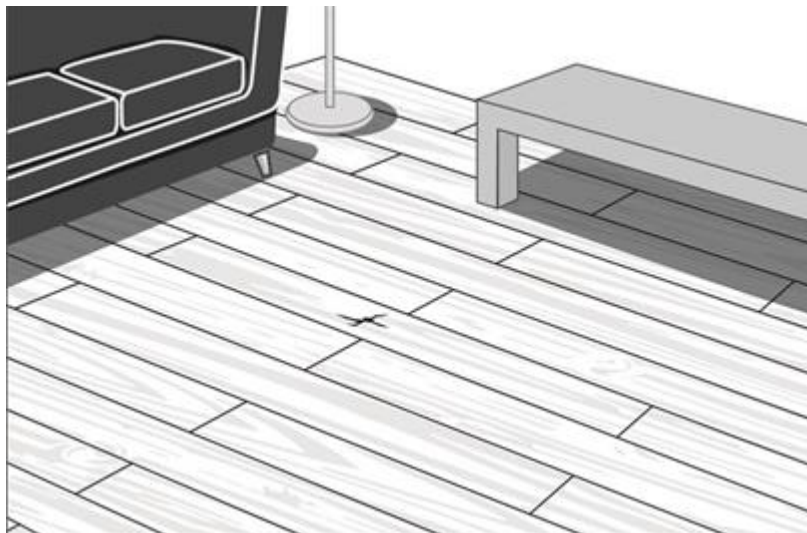

remove the flooring coming from the wall

1.2.

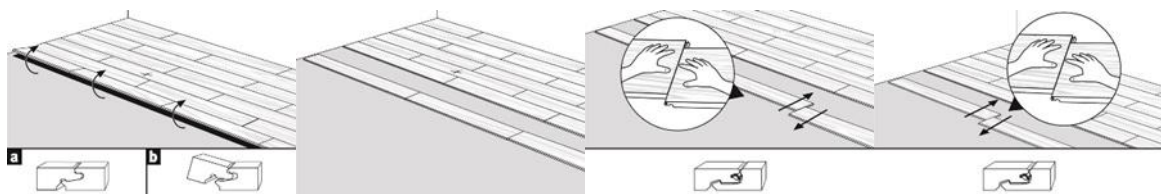

After replacing the damaged plank, this is substituted with a new one, which will be re-install together with the undamaged laminate flooring elements, as described in our installation instructions.

2. Replace a single element

In case the first method is not possible, there is a way to replace one element in the installed laminate flooring area.

2.1. What you need for the replacement:

2.1.1. Replace element (new plank)

For the replacing you need a new element and one or two spare elements.

It is required and absolutely necessary to have the new planks unpacked stored for about one week in the room where the replacement will be done. The reason is that the new plank will be able to acclimatize and adjust to the room atmosphere as well as to the dimension of the laid flooring elements.

2.1.2. Tools

For the replacing, you need:

- pad for the tools
- pencil and marker
- crepe tape
- dipping saw / portable circular saw
- track saw kit for dipping saw
- vacuum cleaner
- a sharp chisel
- a hammer
- glass lifter
- PU - glue / D3 white glue
- weights
- Decor Mix & Fill

You should take to care a basic rule: Your customer is already disappointed because of the damaged flooring. You have a chance as an installer to impress the customer by your professional working. Please use therefore an extra pad/ cover for your tools to protect the laminate flooring.

2.2. Mark the cuts

Tape down the edges of the neighboring elements with a crepe tape (see left picture). This protects the edges of the installed elements.

Start by marking the cuts for the damaged element. Please keep approx. 3-5 mm distance from the edges of the neighboring elements (see right picture).

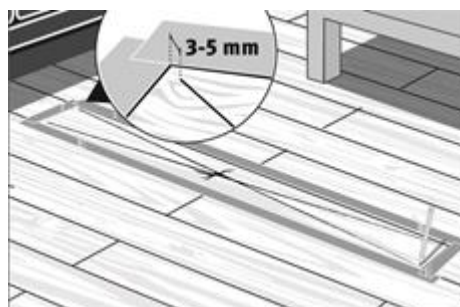
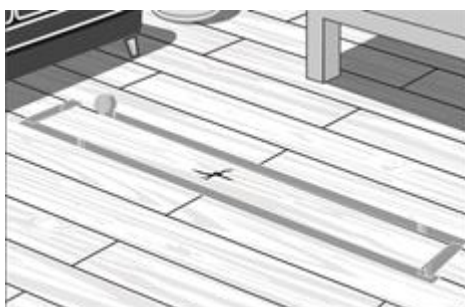

2.3. Sawing

Important:

Before you begin adjust the exact cutting depth of the dipping saw.

Cutting depth = thickness of the element + height of the table track for the dipping saw.

Do not damage the underlayment (moisture barrier and/or sound proofing pad). If you will however damage the underlayment then repair it with vapour proof adhesive tape.

Before cutting we recommend to install the vacuum cleaner to the saw. Cut with the dipping saw along the marking. Stop cutting exactly at the marking before you reach the element edges (see picture).

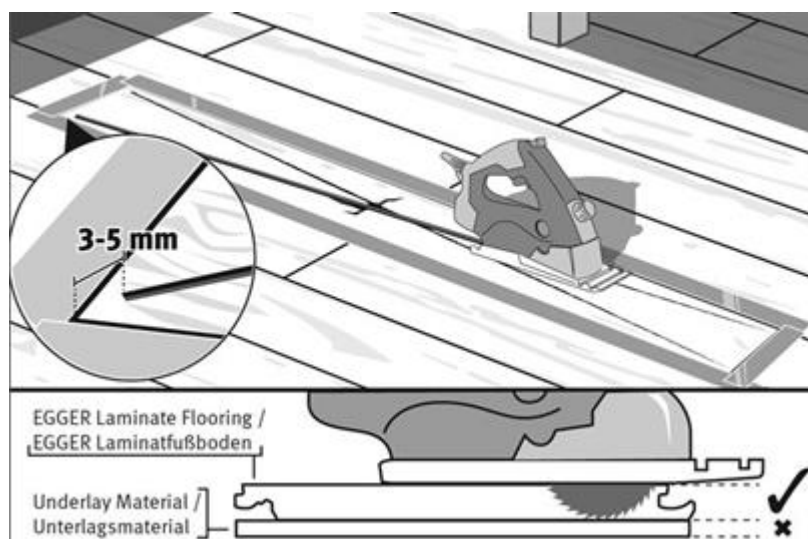

2.4. Element removing

With a chisel break the still existing corner connection between the damaged plank and the remaining floor area (see picture). Start cutting from the edge towards middle of the plank. It can be helpful to drill some small holes in order to remove the rest material pieces easier on the edges.

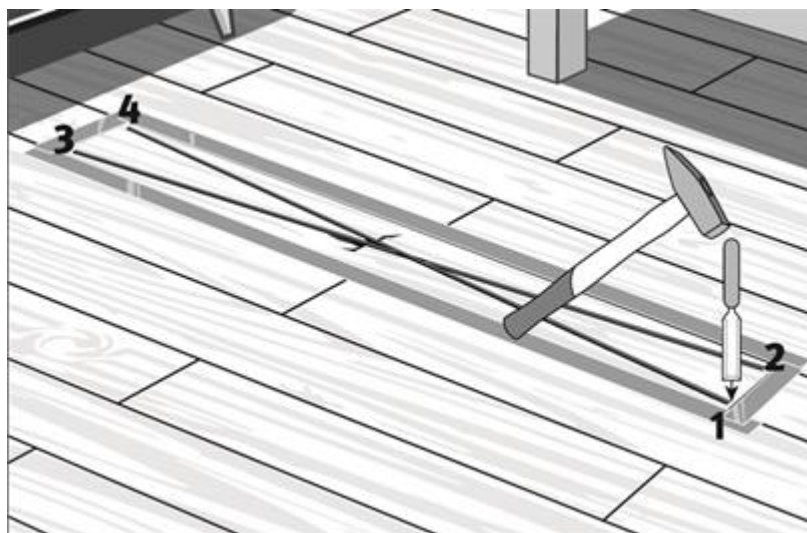

After cutting the connection you can use a chisel in the saw-cut joint, in order to remove the four segments of the element in the numbered specified order (see picture). For this take off the segments by angling and lifting from the clic connection. Please avoid damaging the neighboring elements.

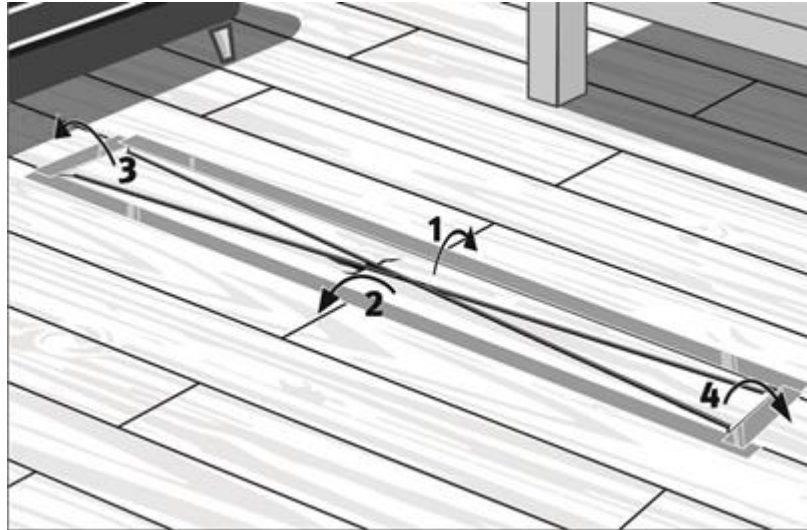

2.5. Cleaning

Clean thoroughly the underlayment and joints of neighboring elements. It is necessary for the fitting precision (meaning no height difference). The best way is to clean with a vacuum cleaner.

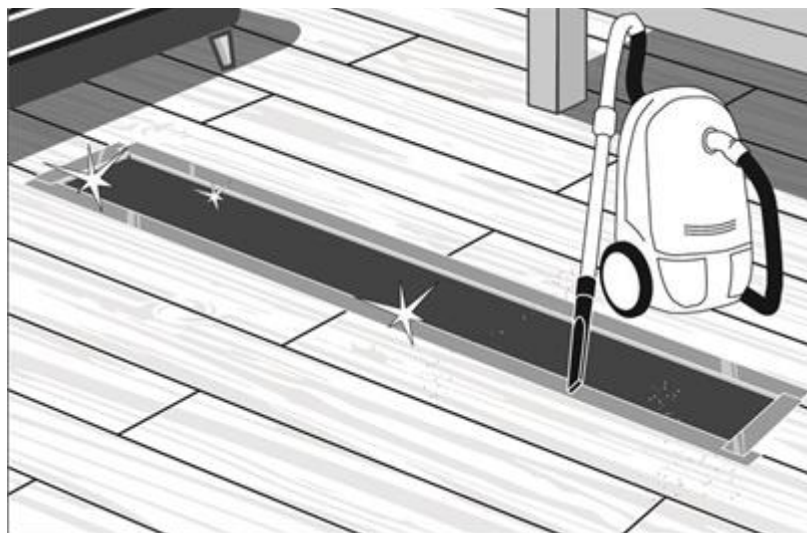

2.6. Preparing the new element

At the new flooring element cut with the dipping saw the tongue and groove of the length side (see picture). Don't forget to adjust the correct depth of the dipping saw.

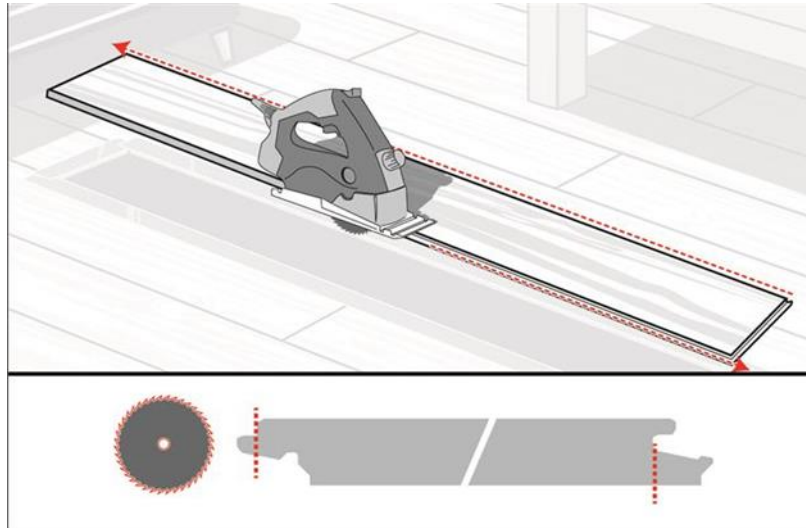

In order not to damage, the original installed flooring, do the cutting some elsewhere or on an extra cover.

2.7. Last check without glue

To test if the replace element will fit into the cleaned opening, please follow next steps:

1. Do not apply any glue during the control.
2. Remove the plastic stripe insert (red or blue coloured) on the new element, as well as on the adjoining element of the installed area. Please keep in mind the position and/or with which side the plastic strip is placed in the flooring elements, because the plastic strip insert must be pushed in after the test run again.
3. Lay first the short side (groove side) in the right position and carefully slide the replace element under the installed element.
4. Lay down the new element carefully lengthwise by using a glass lifter and afterwards push down the short side tongue side until it is even with the laminate flooring surface of the installed area.
5. Check the fitting.
6. If the connection closes evenly, then take off the replace element with a glass lifter.
7. Afterwards set in again the removed plastic stripe inserts into right position.

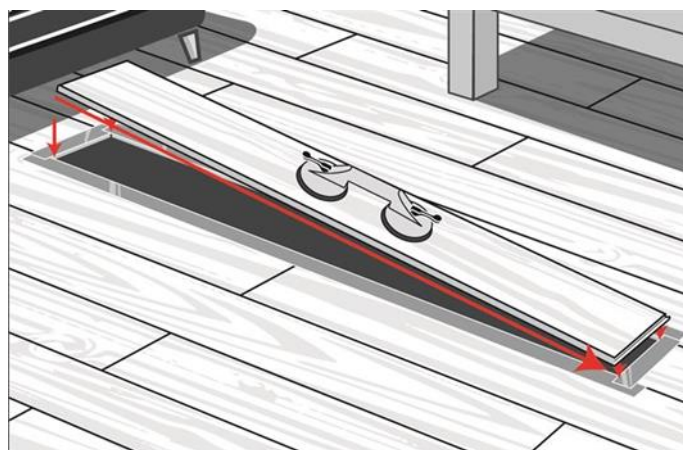

2.8. Gluing and fitting

For the gluing please use PU glue or D3 white glue.

Please add the glue in adequate volume on the top side of tongue and groove.

2.8.1. Glue application at the long side of the adjoining elements

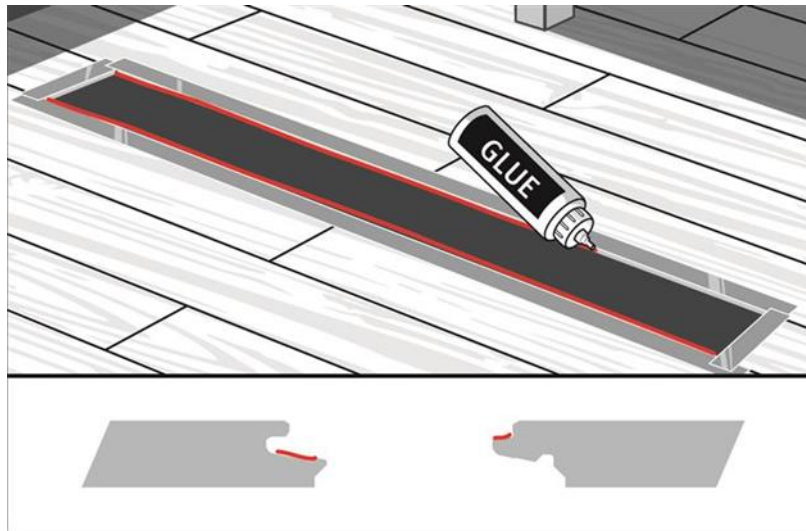

2.8.2. Glue application at the short side groove of the new element

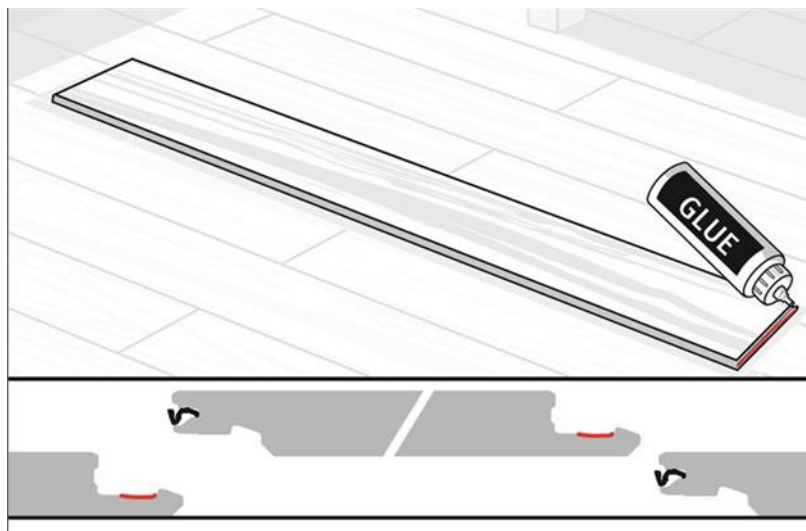

2.8.3. Fitting

Now install the new element with added glue as described under point 2.8. Please work carefully, not to damage the elements.

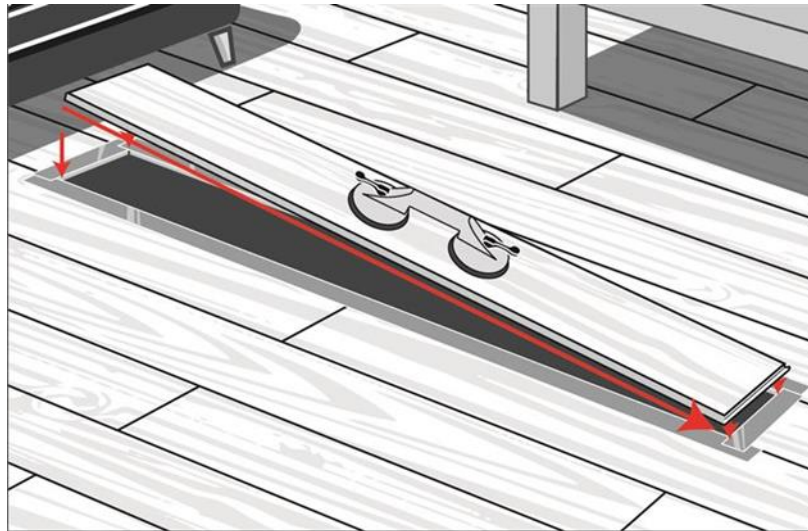

Please remove leaking glue promptly (having regard to manufacturer's instructions) with a spray-moistened cloth. Please check again the accuracy of fitting of the replaced flooring element and weight down it.

3. Final remark

Weight down the fresh installed flooring element for at least 12 hours (for example with books or toolbox) that the glue can harden within 12 hours. After this time, you can burden the flooring area. To avoid vibration in the replaced area it is recommendable to avoid walking on here for 12 hours.

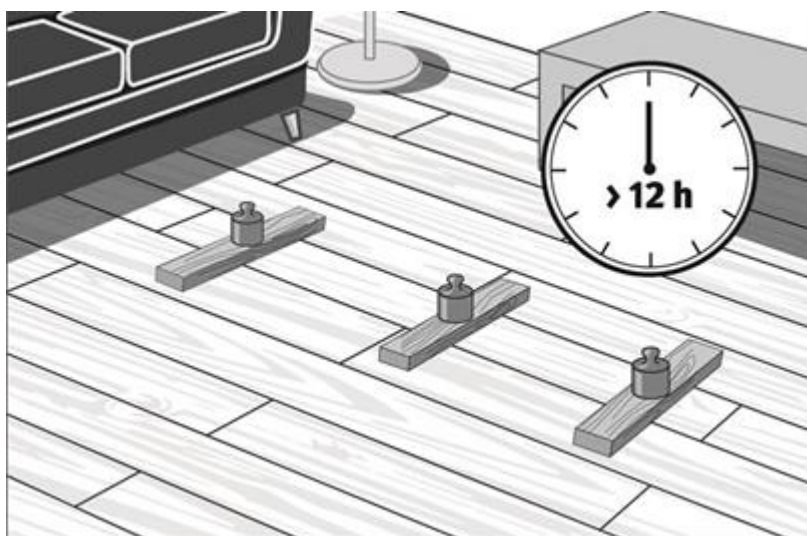

All work steps are completed. Please control once again and clean the flooring to make a professional impression. If you still have minimum gaps fill them with matching Decor Mix & Fill.

4. A last tip:

Replacing an element requires some training. Test the replacing for the first time in your garage before you do it at customer's place.

Tentativeness note:

This processing tip have been issued after the best knowledge and with special care. The information is based on practice experiences as well as own test and corresponds to our today's state of knowledge. This processing tip serve as information and contain no confirmation of product features or suitability intended purposes. For misprint, standard mistake and error no guarantee can be taken over. Besides, technical changes can result from the continuous improvement of EGGER laminate floor as well as from changes in valid standard as well as documents of the public right. Hence, the contents of this processing tip cannot serve as a legally binding basis. Our general terms of sale and terms of delivery are valid basically.